



Dear Valued Customer:

GE Power Conversion, Large Motors group has appointed Parts Super Center as the Preferred Partner for GE Large Motor products. Parts Super Center has over 30 years of experience serving industrial markets and is well positioned to serve this installed base;

- Oil & Gas
- Mining & Metals
- Power & Energy industries
- Pulp & Paper

That, combined with GE's 125 years of motor manufacturing experience, allows Parts Super Center to provide technical expertise and exceptional customer service. With this collective experience, Parts Super Center can help safeguard your facilities from unexpected downtime by providing aftermarket parts and critical spares for your GE Large Motors. Parts Super Center promises to make your needs our priority.

Call us today to hear how we can help. We are ready to serve!

Fred Bird

Program Manager – Motors
Parts Super Center

Fred.Bird@PSCParts.com

M: 814-203-7033

Hani Masoudi

General Manager
Parts Super Center

Hani.Masoudi@PSCParts.com

O: 317-554-3823

Packet Contents:

Product Overview

PSC Line Card



800-727-8443
PartsSuperCenter.com
Sales@PSCparts.com



Transformers



Circuit Breakers
& Switchgear



Industrial Drives
& Controls



Motors

PSC is the National Preferred Partner of GE Large Motor products!



GE offers a full range of horizontal and vertical **Synchronous Motors**, from direct-drive high torque density motors to turbo-type motors for compressor applications.

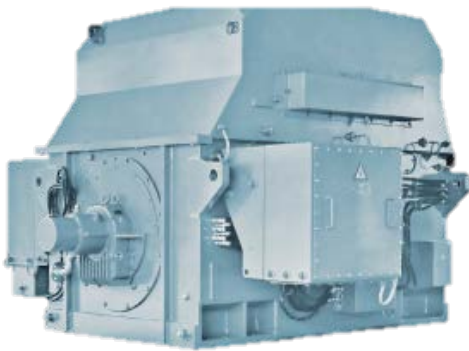

GE's **Induction Motor** technology delivers high reliability with this leaner, lower maintenance motor that consistently delivers the power you need.

Replacement parts available for all types of Large Motors, including horizontal & vertical design in a variety of enclosures.



Transformers



Circuit Breakers
& Switchgear



Industrial Drives
& Controls



Motors

Safeguard from unexpected downtime by stocking your critical spares!

- Sight gauge
- Pre-wound stator core
- Oil rings
- Baffle
- Conduit box

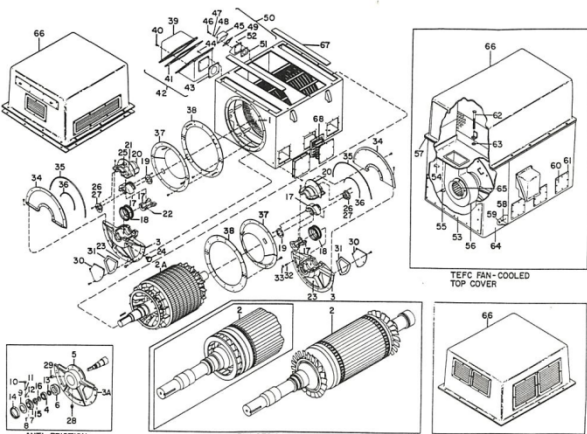
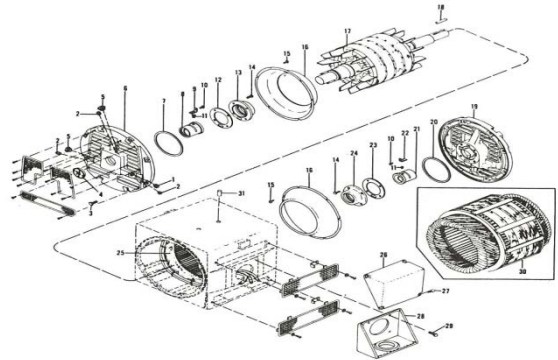

- Exciter spares
- Bearing bracket and spares
- Rotor bars and end rings
- Slip rings assemblies

Experts on all GE Product Lines, let us serve you.

Circuit Breakers & Switchgear

Circuit Breakers & Switchgear Parts

Low (AK/AKR/WavePro), PowerBreak I&II, Medium (Magneblast, PowerVac) & High Voltage (ATB)

- Coils, Relays & Solenoids
- Contacts
- Control Valves
- Elevating Mechs
- EntelliGuard Trip Units
- Mechanism Parts
- Motors
- MVA Upgrades
- Positive Interlocks
- Primary Disconnects
- Remote Racking Mechanisms
- Shutters
- Switches & Disconnects

New Circuit Breakers

- AK/AKR
- EntelliGuard-R Retrofill
- EntelliSys
- GE SecoVac
- Magneblast
- WavePro

Oil Circuit Breakers

High Voltage (FK/FKA/FKD/FGK)

- Air Compressors
- Bushings
- Contact Rods
- Control Valves
- Fused Oil Cutouts
- Gaskets & O-Rings
- Mechanisms
(MA 13/14/15/16/18/19)
- Trip & Coils

Industrial Drives & Controls

Distribution Control

Mebane

- Fuses
- Limit Amp
- Motor Control Centers

Drive Systems

Salem, Fuji

- Brakes
- Circuit Boards (New & Remanufactured)
- Capacitors
- Coils
- Contact Tips
- DC Contactors
- Grounding & Power Resistors
- Lever & Cam Limit Switches
- Master Switches
- Protective Relays
- Rheostats
- Selsyns

General Purpose Control

- Auxiliary Contacts
- Coils
- Heaters
- Industrial & Overload Relays
- Industrial & Heavy-Duty Solenoids
- IEC Power Devices
- Lighting Contactors
- Medium Voltage Fuses
- Pilot & Signaling Devices
- Push Buttons
- Starters & Contactors
- Terminal Boards & Blocks

Power Management

Grid Solutions (Multilin), ITI (Instrument Transformers, Inc.)

- Current Transformers
- Digital Relays
- Electro-mechanical Relays
- ET Indicating Lamps
- Motor & Transformer Protection
- SB & SBM Switches
- Terminal Boards

Transformers

Transformer Parts

Power, Sub-Station & Distribution
Pittsfield, Prolec, Rome, Hickory & Shreveport

- Bushings
- Capacitors & Arresters
- Cooling Packages
- Gasket Kits
- Heat Exchangers
- Load Tap Changers
- MVA Upgrades
- Pumps & Gages
- Protection Systems
- Radiators
- Secondary Arresters
- Switches
- Vacuum Interrupters

Replacement Transformers

Sub-Station Retrofits

- Dry Cast Coil
- Liquid Filled
- Load Interruptor Switch
- Pole & Padmount
- Vaportran

Bushing Potential Device

- Cables
- GE KA-108

Voltage Regulators

- Inductrol
- Step Voltage Regulator

Motors

Motor Parts

- AC/DC Motors
- Armatures & Coils
- Bearings
- Brushholders & Springs
- Carbon Brushes
- Fans & Blowers
- K3 Motors
- Permanent Magnet Motors

